

SUITE 210 | AVAILABLE NOW

1275 W WASHINGTON ST



50,061 SF Demisable Office Space Available For Sublease



WATCH FULL VIDEO
OF PROPERTY



CONTACT

Matt Beeks
mbeeks@keyser.com
480.369.8977

Noah Barrasso
nbarrasso@keyser.com
602.680.8752

1275 W WASHINGTON ST / TEMPE, AZ 85288

Sublease Overview



Suite 210

Situated within The Arroyo, suite 210 is designed with convenience and comfort in mind, featuring multiple kitchens, spacious break rooms, and an in-suite private gym for tenants. The location provides easy access to dining options and is just minutes from Sky Harbor Airport, downtown Tempe, Papago Park, and Rolling Hills Golf Course.

Suite Features

50,061 SF

Space Available

\$20.00/SF Full Service

Rental Rate

Furniture Included

Plug & Play

7/31/29

Lease Expiration

5.66/1000 SF

Parking Ratio

Available Now

Move-In Ready



2ND FLOOR | 50,061 SF

46 Offices

222 Cubicles

5 Kitchen/Break Areas

9 Conference Rooms

1 Training Room (Located on 1st Floor)

SUGGESTED DEMISABILITY

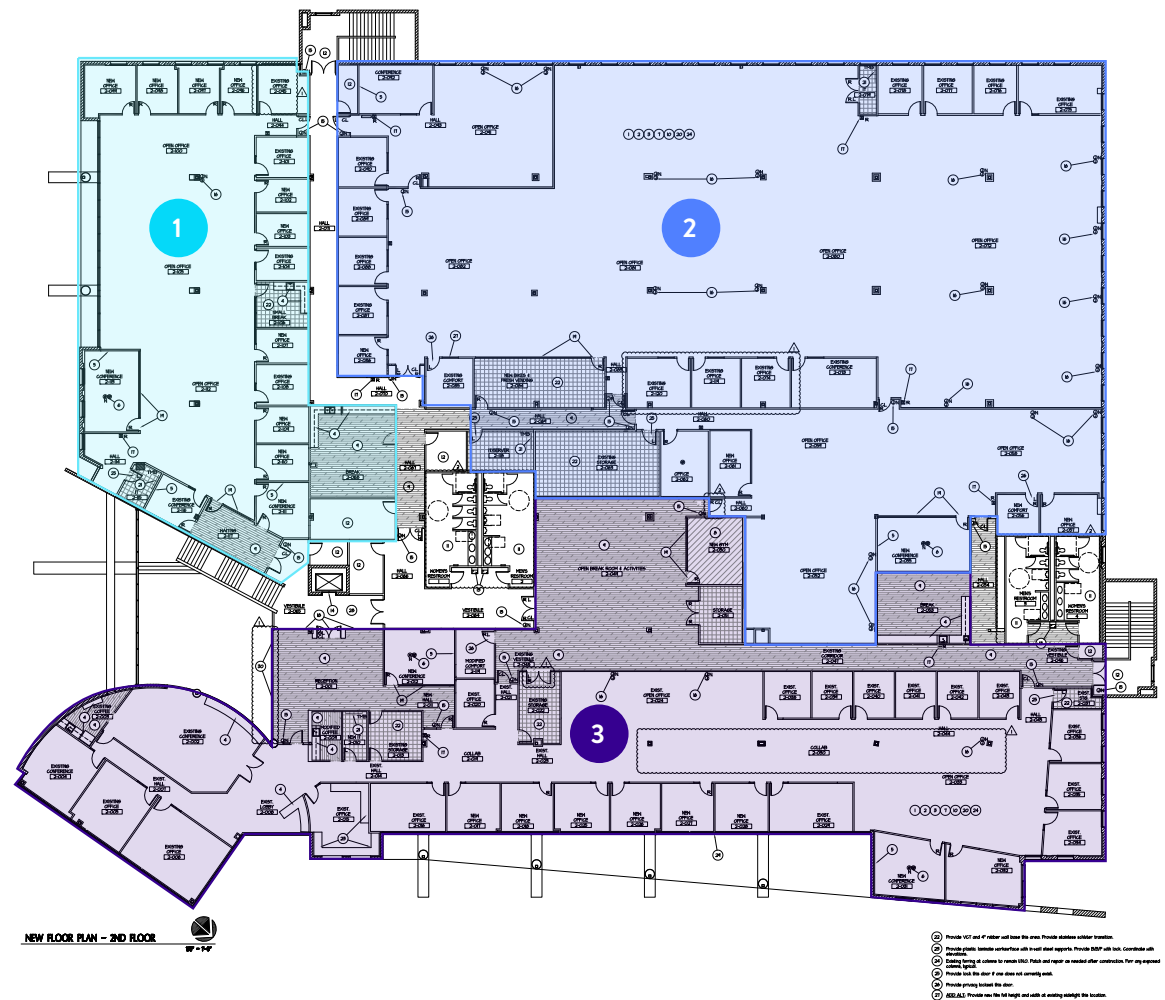

**Conceptual demising plan. Actual demising will require consultation with an architect and appropriate permitting.*

Demised Floor Plan



DEMISED SUITE 1 |

+/- 7,585 SF

14 Offices

40 Cubicles

2 Kitchen/Break Areas

3 Conference Rooms

**Conceptual demising plan. Actual demising will require consultation with an architect and appropriate permitting.*

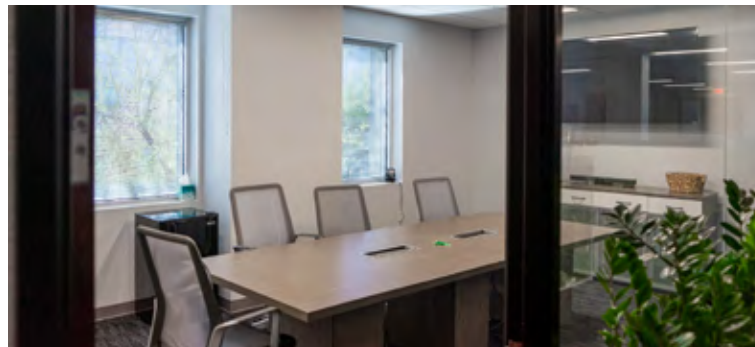
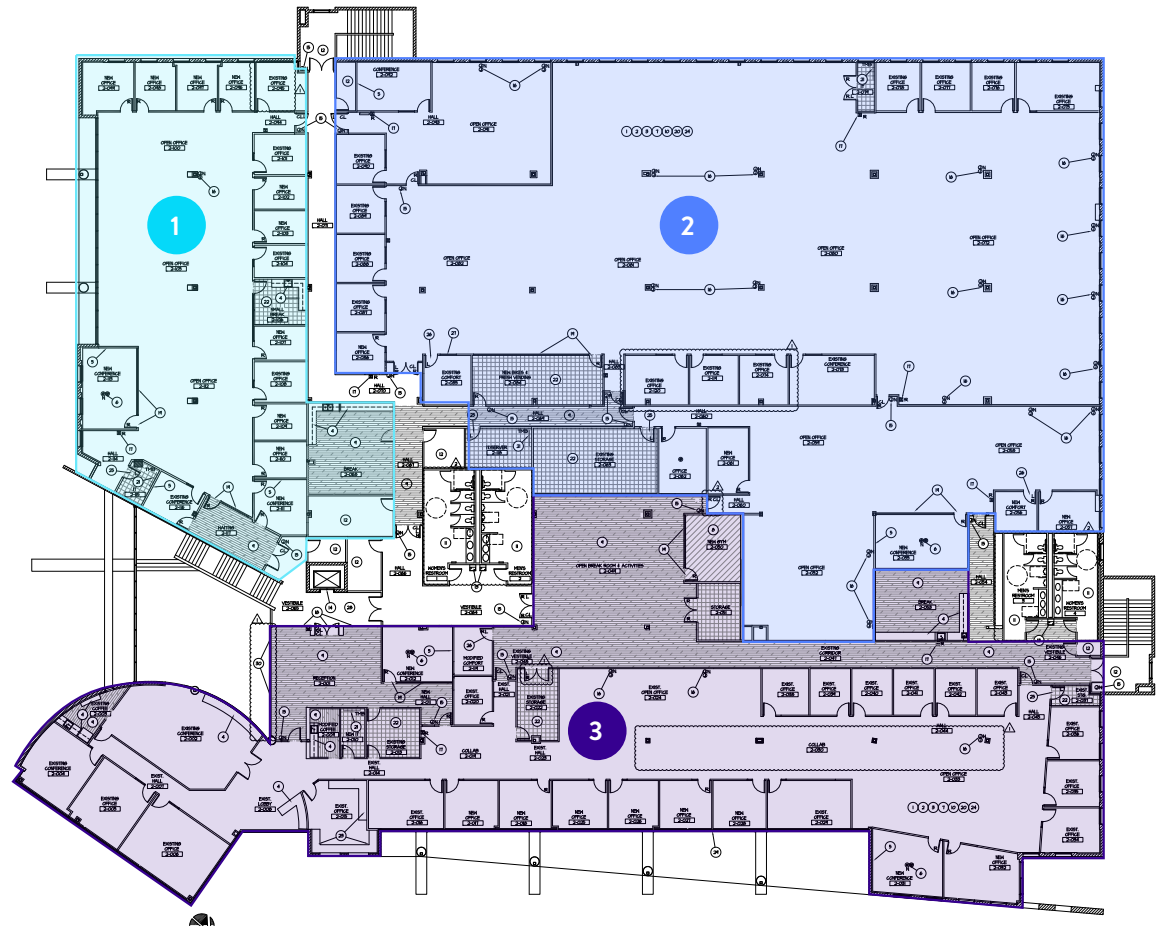

Demised Floor Plan



DEMISED SUITE 2 |

+/- 23,737 SF

14 Offices

170 Cubicles

1 Break Area

3 Conference Rooms

**Conceptual demising plan. Actual demising will require consultation with an architect and appropriate permitting.*

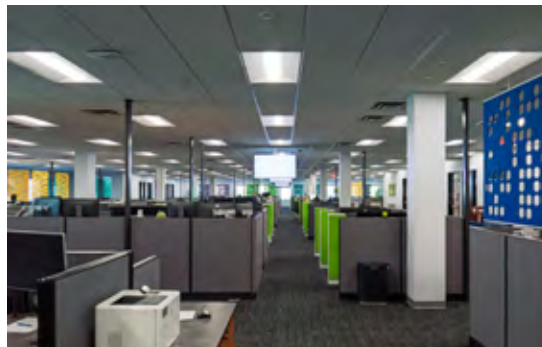
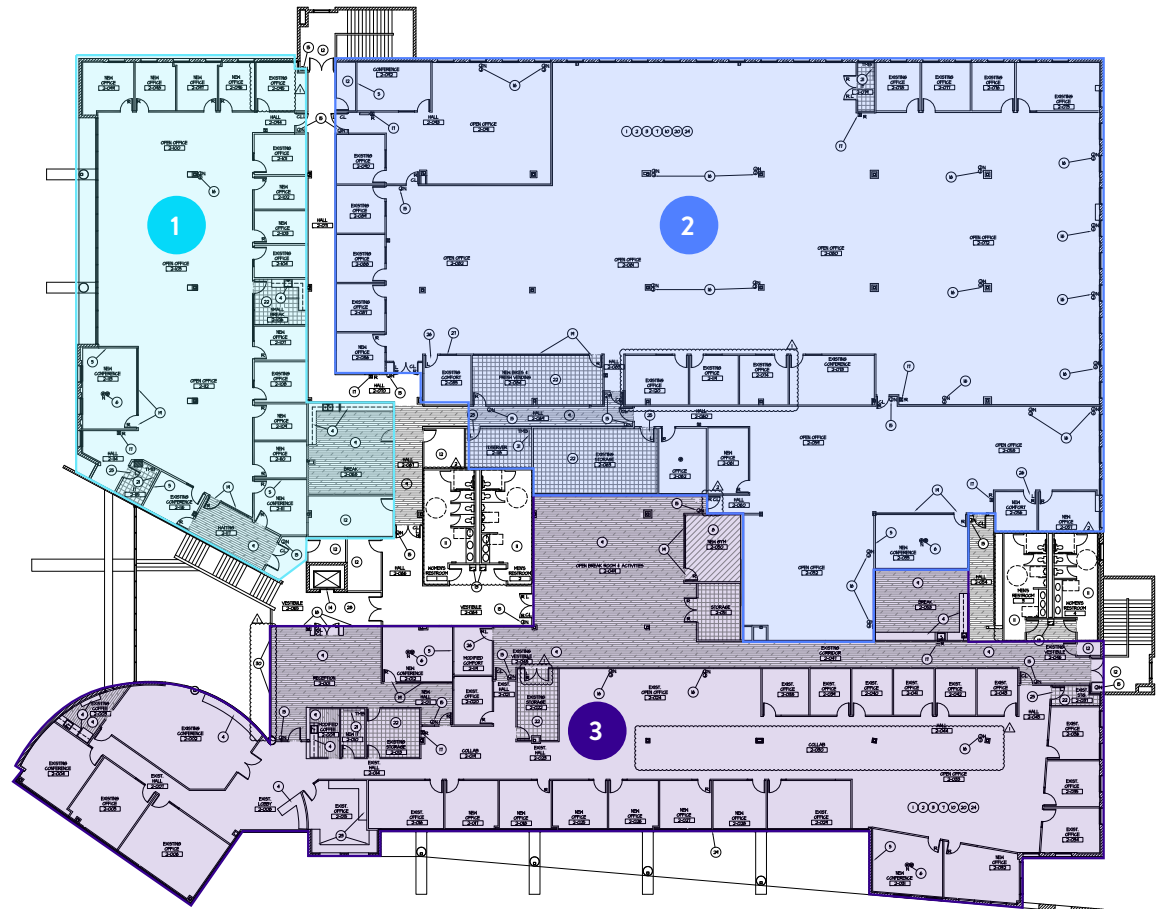

Demised Floor Plan



DEMISED SUITE 3 |

+/- 16,339 SF

22 Offices

12 Cubicles

2 Kitchen/Break Areas

3 Conference Rooms

**Conceptual demising plan. Actual demising will require consultation with an architect and appropriate permitting.*

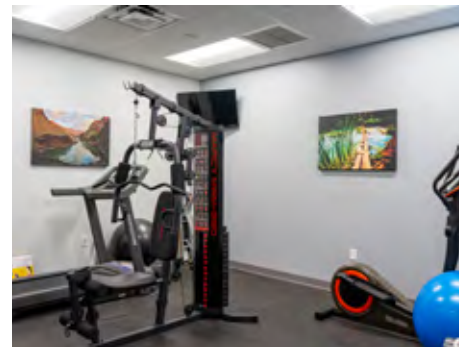
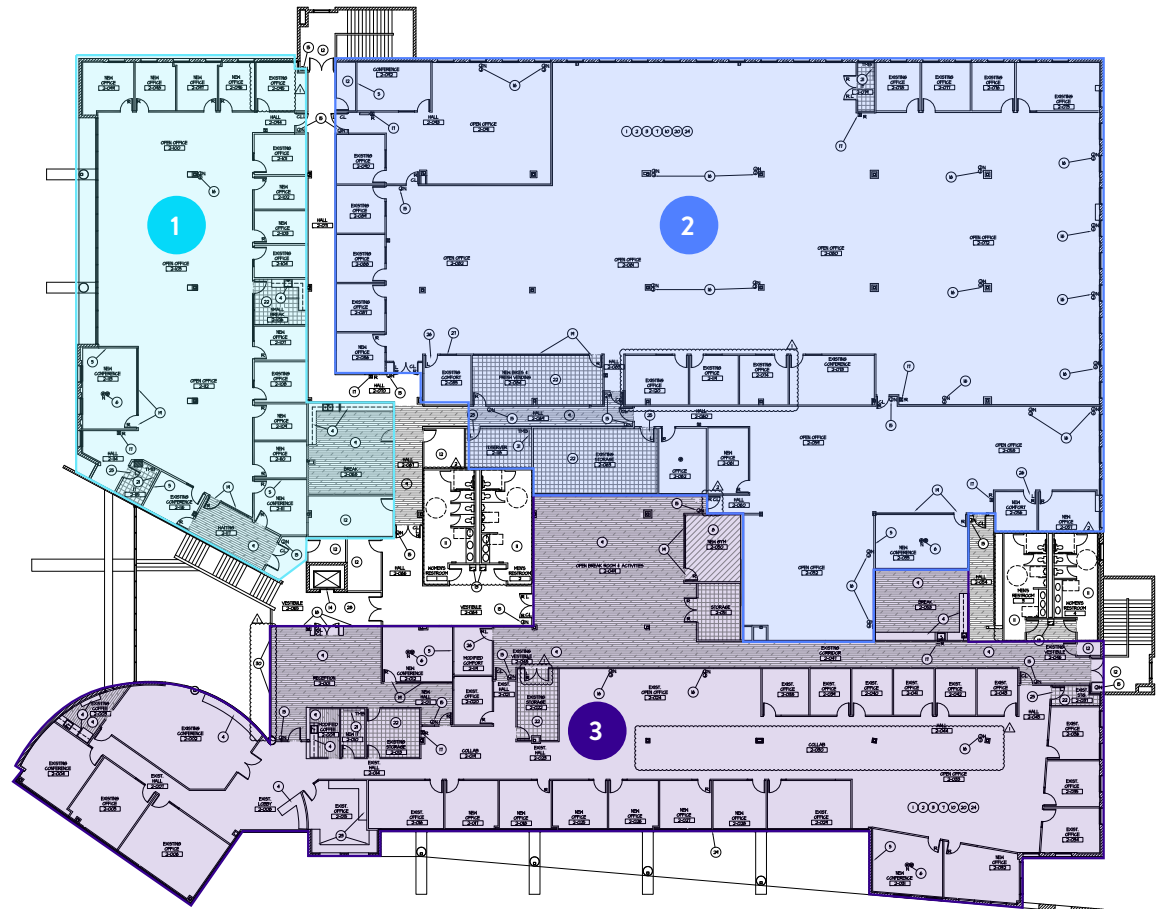

The Arroyo



Overview

The Arroyo in Tempe is a thoughtfully designed campus that fosters innovation, collaboration, and productivity. Blending modern workspaces with natural surroundings, it offers a walkable environment with scenic paths, green spaces, and easy access to major business and lifestyle hubs. Its strategic location provides convenience for professionals while enhancing the overall work experience.

Campus Amenities

- + Nature paths throughout campus
- + Fitness Center with showers
- + Cafe (Coming Soon)



Drive Times

- # Corporate Neighbors

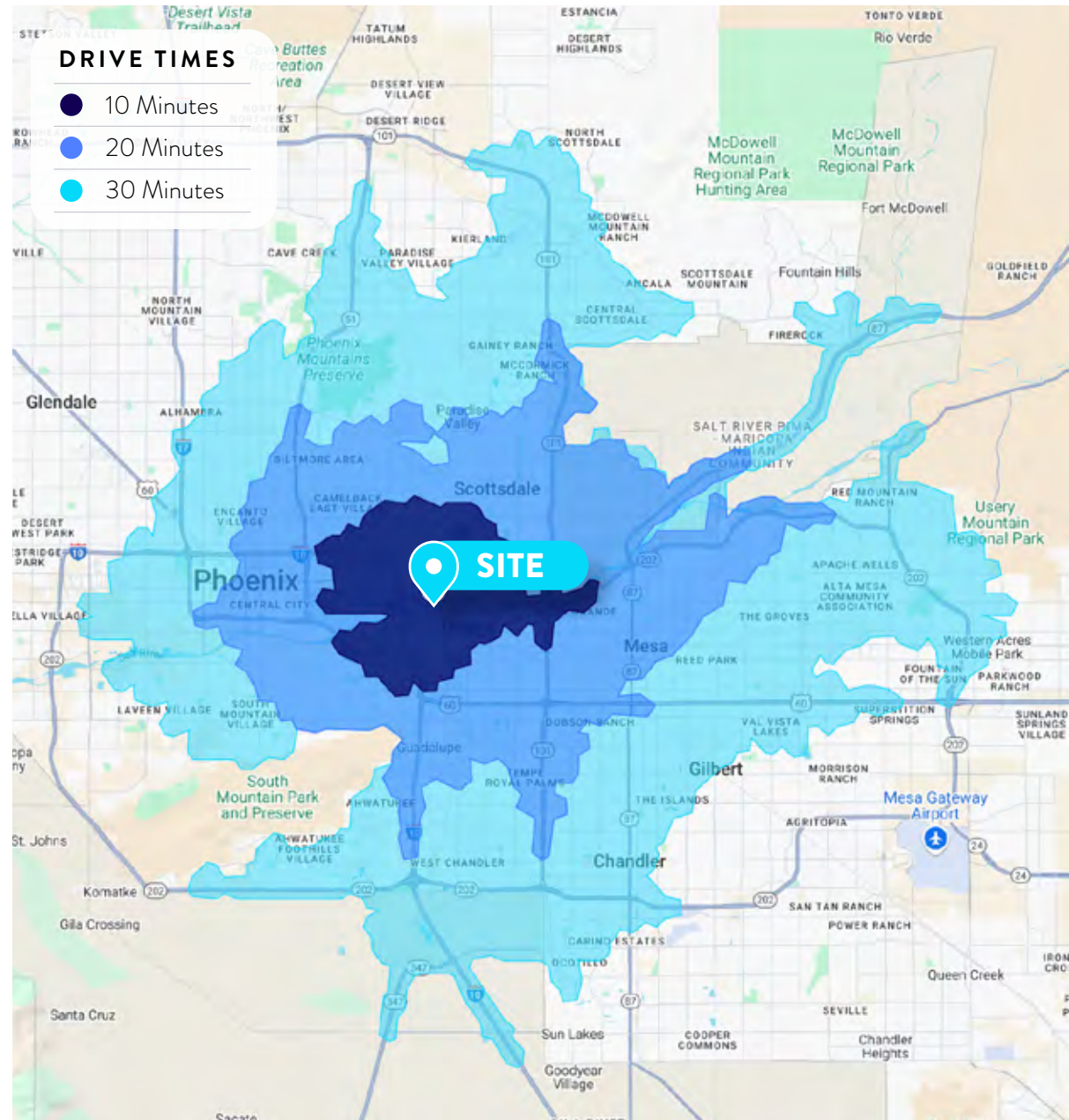

CONTACT

Matt Beeks

mbeeks@keyser.com

480.369.8977

Noah Barrasso

nbarrasso@keyser.com

602.680.8752



Thank You

Keyser | Commercial Real Estate Advocates | Keyser.com

© 2025 Keyser, LLC. All rights reserved. Keyser, LLC has not independently verified the information contained in this document, and makes no guarantee, warranty, or representation, expressed or implied, about the accuracy or completeness of the information. It is your responsibility to independently confirm the accuracy and completeness of the information, and to conduct your own due diligence. You further acknowledge and agree that Keyser LLC is not acting as your fiduciary or agent and owes no duty to you, and it shall not be liable for your use of the information or any errors or omissions. Any projections, opinions, assumptions, or estimates used are for example only and are not intended to guarantee or represent the current or future performance of the property. The value of this transaction to you depends on tax and other factors which should be evaluated by your tax, financial, and legal advisors. You and your advisors should conduct a careful, independent investigation of the property to determine to your satisfaction the suitability of the property for your needs. Photos herein are the property of their respective owners and use of these images without the express written consent of the owner is prohibited.